

Barnacre Solar Farm

Application Presentation

Tuesday 10.10.2023

Introduction

Noventum

James Walker, Planning Lead – with apologies

Pegasus Group

Richard Morison, Associate Planner

Barnacre Solar Farm

Planning Application

- Now submitted to Wyre Council
- Validated 27.09
- Application Reference 23/00902/FULMAJ
- Publicly accessible and available to view online via Council's website
- Council Consultation phase of the application
- Target determination early January 2024

Purpose of Presentation

- Provide an overview of the design
- Signpost where to find key information within the Planning Application package
- Provide overview of planning process
- Take questions

Site Layout

Key Points

- 23MW output – Enough energy for approx. 7,000 homes
- 42 hectare land use
- Extensive Landscaping Plan
- On-site attenuation basin
- Significant bio-diversity net gain – 128.23% area based, 45.46% linear-based habitats
- 93.6% of site lower grade agricultural land
- Construction access routing avoiding Garstang and Bonds
- On-site footpath improvement works

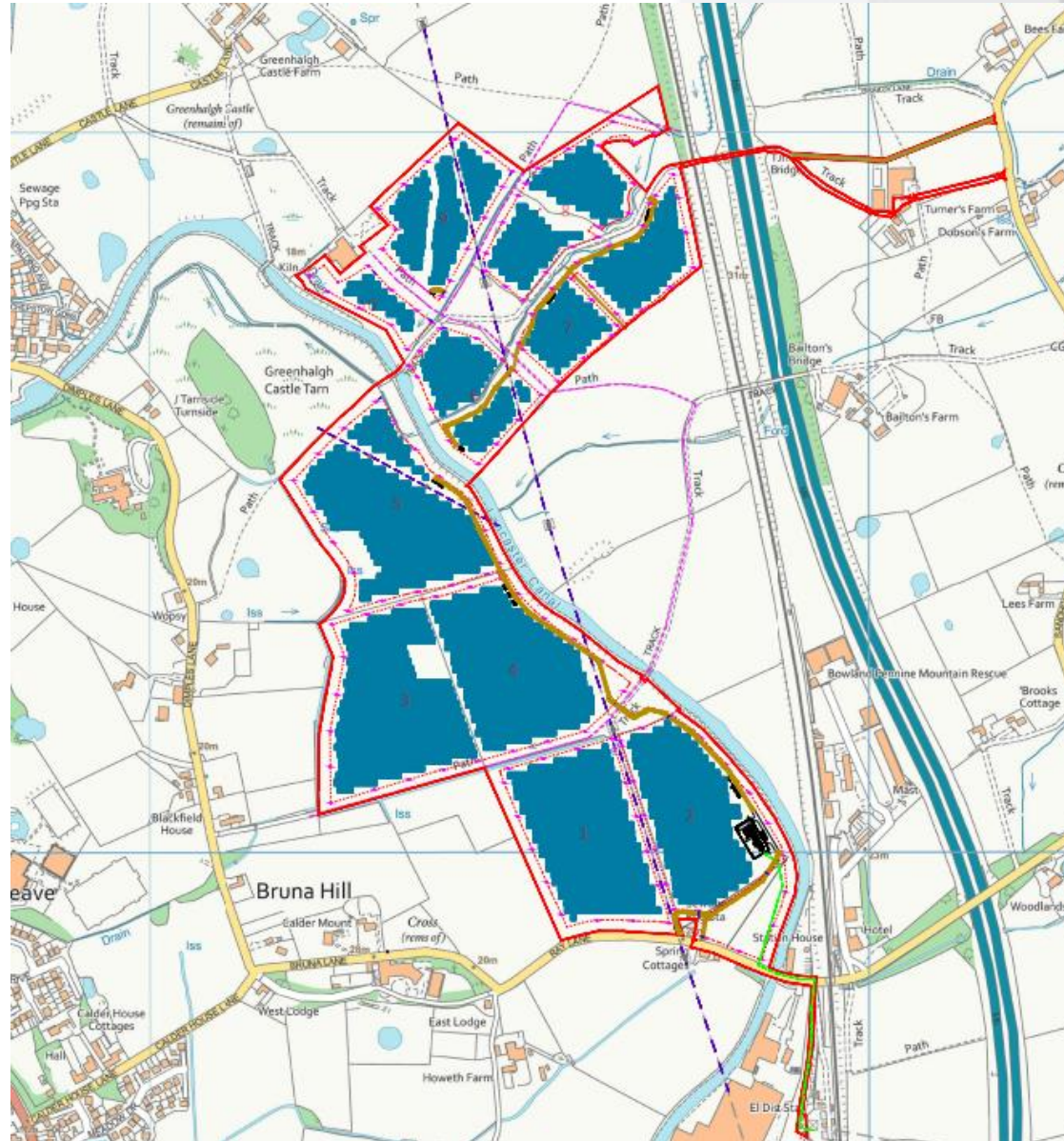

Landscaping Plan (1)

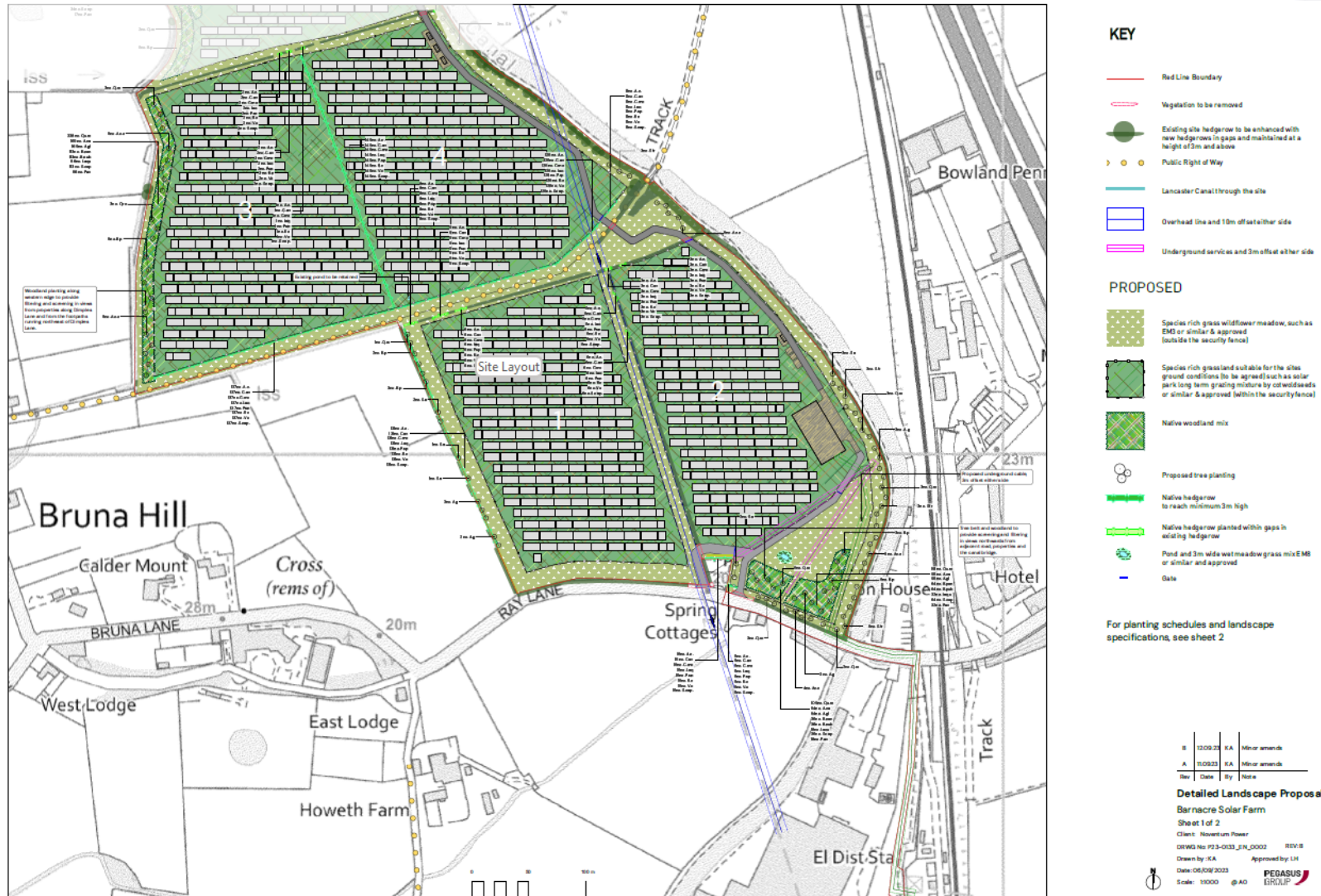

Expertly Done.

Key Points

- 157 individual trees planted across the site
- Woodland mix on top of this
- Hedgerow planting on top of this

Landscaping Plan (2)



Expertly Done.

Highways Access

Turners Farm Access



Ray Lane Access

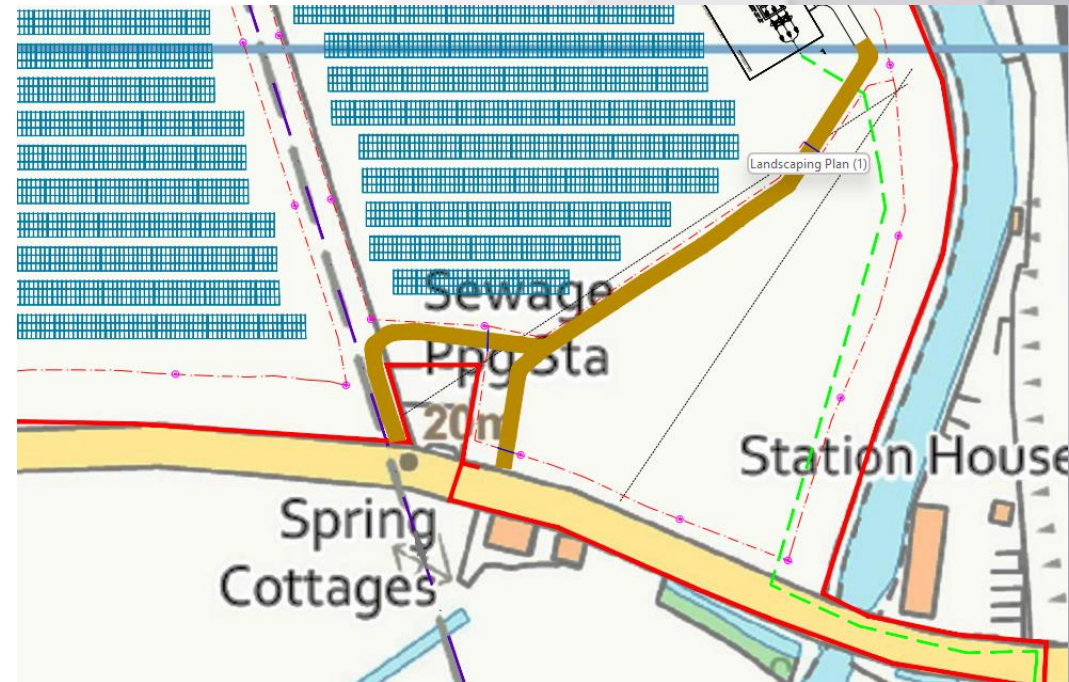

Expertly Done.

Highways Routing

Plate 4.1 – Proposed Construction Routes

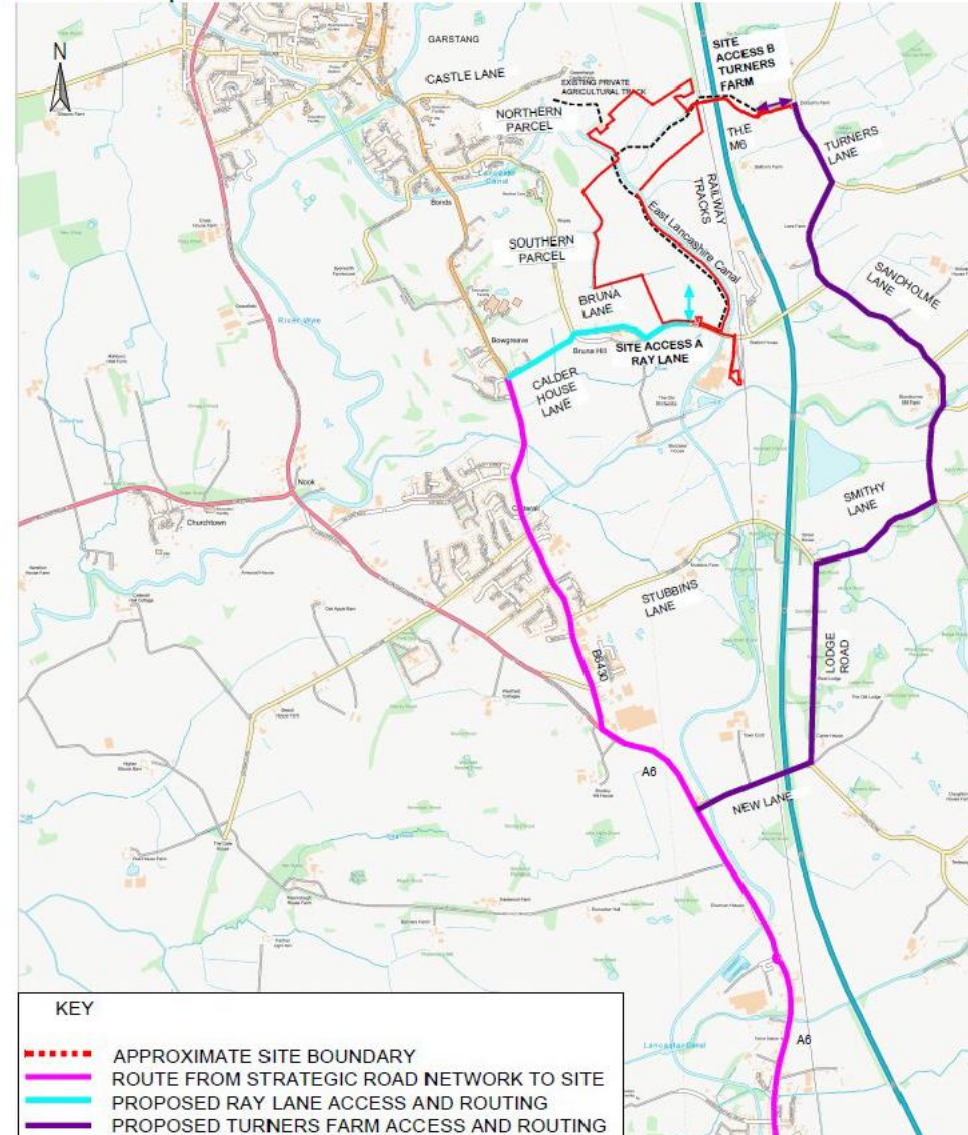

Expertly Done.

Flood Water Attenuation

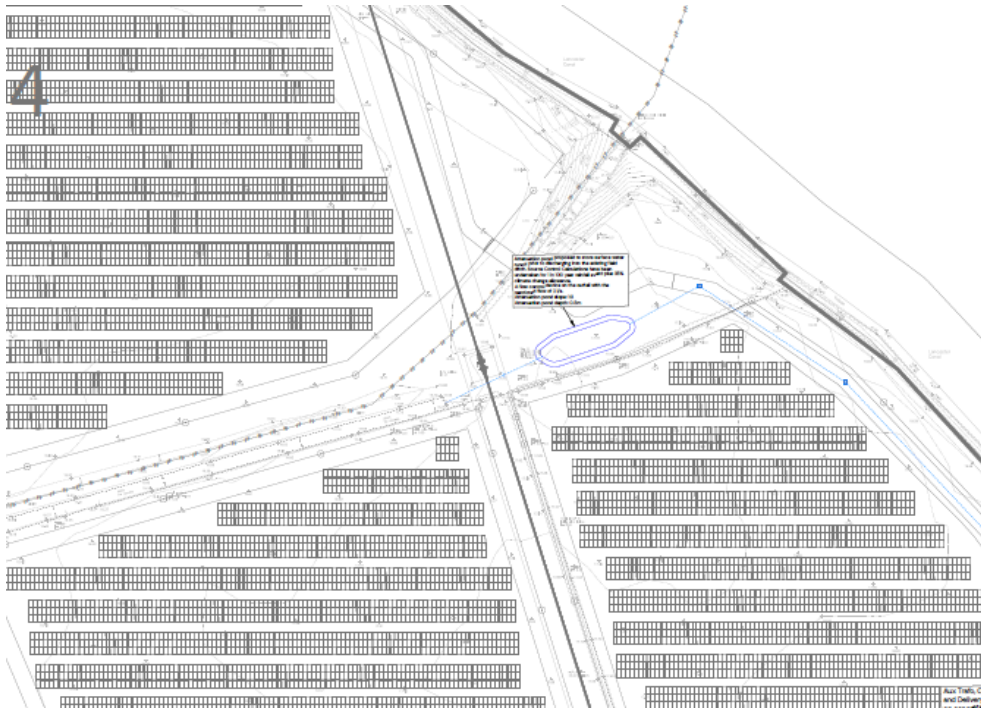

Attenuation pond proposed to store surface water runoff prior to discharging into the existing field ditch. Source Control Calculations have been undertaken for 1 in 100 year rainfall event plus 35% climate change allowance. A flow control device on the outfall with the restricted flow of 2 l/s.
Attenuation pond slope: 1:3
Attenuation pond depth: 0.5m

Expertly Done.

Planning Application Package

- Drawings
- Planning Statement
- Design and Access Statement
- Sequential and Exceptions Test
- Site Selection Report
- Landscape and Visual Impact Assessment
- Landscape Masterplan
- Ecological Impact Assessment
- Biodiversity Net Gain metric
- Flood Risk Assessment and Drainage Strategy
- Heritage Statement
- Construction Traffic Management Plan
- Agricultural Land Classification Survey
- Arboricultural Impact Assessment
- Photomontages

Thank you for having me.

Richard Morison

Associate Planner

E: richard.morison@pegasusgroup.co.uk

T: 07557 162529

James Walker

Lead Planner

E: James@noventumpower.co.uk

T: 07742 005126

Expertly Done.

DESIGN | ECONOMICS | ENVIRONMENT | HERITAGE | PLANNING | PROPERTY | TRANSPORT & INFRASTRUCTURE